



SSC MTS **SHIFT – 3 (19-06-2023)**

- ★ **Latest Govt Job updates**
- ★ **Private Job updates**
- ★ **Free Mock tests available**

Visit - teachingninja.in

Multi Tasking Non Technical Staff and Havaladar CBIC and CBN Examination 2022

Roll Number	
Candidate Name	
Venue Name	
Exam Date	19/06/2023
Exam Time	3:30 PM - 5:00 PM
Subject	MTS Non Tech Havaladar CBIC and CBN Examination 2022

Section : Numerical and Mathematical Ability

Q.1 The curved surface area of a cylinder is 968 cm^2 . If the height of the cylinder is 11 cm, then what will be the diameter of its base?

- Ans**
- 1. 26 cm
 - 2. 22 cm
 - 3. 28 cm
 - 4. 24 cm

Question Type : MCQ
Question ID : 264330135411
Option 1 ID : 264330530554
Option 2 ID : 264330530551
Option 3 ID : 264330530553
Option 4 ID : 264330530552
Status : Answered
Chosen Option : 3

Q.2 A train starts moving from a place A at 10:00 a.m. and arrives at another place B at 5:30 p.m. on the same day. If the speed of the train is 80 km/hr, then what will be the distance covered by the train?

- Ans**
- 1. 600 km
 - 2. 550 km
 - 3. 650 km
 - 4. 450 km

Question Type : MCQ
Question ID : 264330138017
Option 1 ID : 264330540675
Option 2 ID : 264330540676
Option 3 ID : 264330540678
Option 4 ID : 264330540677
Status : Answered
Chosen Option : 1

Q.3 A man earns a profit of 35 percent by selling a chair for a certain price. If he sells that chair at double the price, then what will be the profit percentage?

- Ans**
- 1. 170 percent
 - 2. 70 percent
 - 3. 180 percent
 - 4. 150 percent

Question Type : **MCQ**
Question ID : **264330138022**
Option 1 ID : **264330540697**
Option 2 ID : **264330540698**
Option 3 ID : **264330540695**
Option 4 ID : **264330540696**
Status : **Answered**
Chosen Option : **2**

Q.4 The current population of the town is 68,000. The population increases by 10 percent in the first year and decreases by 5% in the second year. Find the population after 2 years.

- Ans**
- 1. 71,060
 - 2. 68,500
 - 3. 69,000
 - 4. 70,100

Question Type : **MCQ**
Question ID : **264330138424**
Option 1 ID : **264330542303**
Option 2 ID : **264330542304**
Option 3 ID : **264330542306**
Option 4 ID : **264330542305**
Status : **Answered**
Chosen Option : **1**

Q.5 Ramesh runs at the speed of 234 kmph. How many metres does he run in ten minutes?

- Ans**
- 1. 35468 m
 - 2. 39000 m
 - 3. 37560 m
 - 4. 36000 m

Question Type : **MCQ**
Question ID : **264330138759**
Option 1 ID : **264330543646**
Option 2 ID : **264330543644**
Option 3 ID : **264330543643**
Option 4 ID : **264330543645**
Status : **Answered**
Chosen Option : **2**

Q.6 The difference between compound interest and simple interest on a sum at 20% per annum for two years is Rs. 420. Find the sum (in Rs.).

- Ans**
- 1. Rs. 8000
 - 2. Rs. 10500
 - 3. Rs. 9000
 - 4. Rs. 11000

Question Type : **MCQ**
Question ID : **264330138403**
Option 1 ID : **264330542222**
Option 2 ID : **264330542220**
Option 3 ID : **264330542221**
Option 4 ID : **264330542219**
Status : **Answered**
Chosen Option : **1**

Q.7 The ratio of speed of three racers is 5 : 2 : 1. What is the respective ratio of time taken by the three racers to cover the same distance?

- Ans**
- 1. 2 : 5 : 10
 - 2. 2 : 5 : 8
 - 3. 5 : 2 : 10
 - 4. 2 : 5 : 3

Question Type : **MCQ**
Question ID : **264330138024**
Option 1 ID : **264330540705**
Option 2 ID : **264330540703**
Option 3 ID : **264330540704**
Option 4 ID : **264330540706**
Status : **Answered**
Chosen Option : **1**

Q.8 Average age of 14 teachers is 56 years. After involving a new teacher in that group, the average rises by 2 years. What is the age of the new teacher?

- Ans**
- 1. 86 years
 - 2. 72 years
 - 3. 84 years
 - 4. 78 years

Question Type : **MCQ**
Question ID : **264330138018**
Option 1 ID : **264330540679**
Option 2 ID : **264330540680**
Option 3 ID : **264330540681**
Option 4 ID : **264330540682**
Status : **Answered**
Chosen Option : **1**

- Q.9** The pie chart given below shows the number of students studying in six schools. Total number of students studying in all these six schools are 4000. Number of students studying in a particular school is shown as a percentage of total number of students studying in all these six schools.

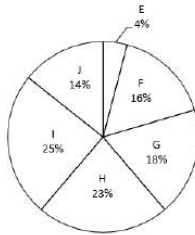

What is the difference between the central angle formed by sectors F and H together and the central angle formed by sectors I and G together?

- Ans**
- 1. 9.6 degree
 - 2. 14.4 degree
 - 3. 17.4 degree
 - 4. 18.7 degree

Question Type : **MCQ**
Question ID : **264330138034**
Option 1 ID : **264330540744**
Option 2 ID : **264330540743**
Option 3 ID : **264330540746**
Option 4 ID : **264330540745**
Status : **Answered**
Chosen Option : 2

- Q.10** An item is sold for Rs. 1440 after two successive discounts of 25 percent and 4 percent. What is the marked price of the article?

- Ans**
- 1. Rs. 2000
 - 2. Rs. 2500
 - 3. Rs. 2100
 - 4. Rs. 2200

Question Type : **MCQ**
Question ID : **264330138027**
Option 1 ID : **264330540718**
Option 2 ID : **264330540717**
Option 3 ID : **264330540715**
Option 4 ID : **264330540716**
Status : **Answered**
Chosen Option : 1

Q.11 Simplify: $44 + 67 - 32 \div 4 + (9 + 5 + 5 + 4) - 1$

- Ans
- 1. 130
 - 2. 125
 - 3. 122
 - 4. 123

Question Type : MCQ
Question ID : 264330138746
Option 1 ID : 264330543593
Option 2 ID : 264330543592
Option 3 ID : 264330543594
Option 4 ID : 264330543591
Status : Answered
Chosen Option : 2

Q.12 The given table shows the number of boys and girls in the schools. Which school has minimum number of students?

School	Number of boys	Number of girls
1	44	56
2	34	45
3	47	34
4	65	54
5	45	32

- Ans
- 1. 2
 - 2. 3
 - 3. 5
 - 4. 1

Question Type : MCQ
Question ID : 264330133751
Option 1 ID : 264330524027
Option 2 ID : 264330524028
Option 3 ID : 264330524029
Option 4 ID : 264330524030
Status : Answered
Chosen Option : 3

Q.13 If $(7x + y) : (7x - y) = 7 : 2$, then what is the value of $x : y$?

- Ans
- 1. 9 : 35
 - 2. 11 : 42
 - 3. 6 : 41
 - 4. 17 : 52

Question Type : MCQ
Question ID : 264330138023
Option 1 ID : 264330540701
Option 2 ID : 264330540702
Option 3 ID : 264330540700
Option 4 ID : 264330540699
Status : Answered
Chosen Option : 1

Q.14 If 3 boys and 8 girls can do a work in 6 days, and 1 boy and 5 girls can finish the same in 12 days, find the ratio of efficiencies of a boy and a girl.

- Ans** ✓ 1. 2:1
✗ 2. 1:5
✗ 3. 2:5
✗ 4. 3:2

Question Type : **MCQ**
Question ID : **264330135406**
Option 1 ID : **264330530531**
Option 2 ID : **264330530534**
Option 3 ID : **264330530533**
Option 4 ID : **264330530532**
Status : **Answered**
Chosen Option : 1

Q.15 Solve: $(64 \div 8) - 5 + 4 \times 23 + 45 - 87$

- Ans** ✓ 1. 53
✗ 2. 51
✗ 3. 54
✗ 4. 52

Question Type : **MCQ**
Question ID : **264330133737**
Option 1 ID : **264330523972**
Option 2 ID : **264330523973**
Option 3 ID : **264330523971**
Option 4 ID : **264330523974**
Status : **Answered**
Chosen Option : 1

Q.16 The sum of the two numbers is 400. If the bigger number is decreased by 16% and the smaller number is increased by 16%, then the numbers obtained are equal. Find the smaller number.

- Ans** ✓ 1. 168
✗ 2. 152
✗ 3. 144
✗ 4. 170

Question Type : **MCQ**
Question ID : **264330138396**
Option 1 ID : **264330542193**
Option 2 ID : **264330542192**
Option 3 ID : **264330542191**
Option 4 ID : **264330542194**
Status : **Answered**
Chosen Option : 3

Q.17 What is the Highest Common Factor of $\frac{4}{55}$, $\frac{2}{11}$ and $\frac{8}{22}$?

- Ans
- 1. $\frac{1}{66}$
 - 2. $\frac{3}{88}$
 - 3. $\frac{2}{55}$
 - 4. $\frac{1}{55}$

Question Type : MCQ
Question ID : 264330138030
Option 1 ID : 264330540730
Option 2 ID : 264330540727
Option 3 ID : 264330540728
Option 4 ID : 264330540729
Status : Answered
Chosen Option : 4

Q.18 Ravi drives 200 km from Dungarpur to Udaipur. His average speed is 50 kmph. He leaves Dungarpur at 8:20 a.m. By what time he will reach Udaipur?

- Ans
- 1. 1:00 p.m.
 - 2. 12:20 p.m.
 - 3. 10 a.m.
 - 4. 11:30 a.m.

Question Type : MCQ
Question ID : 264330135113
Option 1 ID : 264330529390
Option 2 ID : 264330529389
Option 3 ID : 264330529387
Option 4 ID : 264330529388
Status : Answered
Chosen Option : 4

Q.19 By selling 100 notebooks, a shopkeeper gains the selling price of 20 notebooks. What is his gain percentage?

- Ans
- 1. 62.4%
 - 2. 22.5%
 - 3. 50.4%
 - 4. 25%

Question Type : MCQ
Question ID : 264330138752
Option 1 ID : 264330543617
Option 2 ID : 264330543618
Option 3 ID : 264330543616
Option 4 ID : 264330543615
Status : Answered
Chosen Option : 4

Q.20 What is the value of $\frac{343}{49} \times \frac{45}{9}$ of $\frac{27}{15} \times \frac{256}{64}$?

- Ans
- 1. 252
 - 2. 262
 - 3. 142
 - 4. 192

Question Type : MCQ
Question ID : 264330137661
Option 1 ID : 264330539254
Option 2 ID : 264330539253
Option 3 ID : 264330539251
Option 4 ID : 264330539252
Status : Answered
Chosen Option : 1

Section : Reasoning Ability and Problem Solving

Q.1 Which two signs should be interchanged to make the given equation correct?

$$9 \div 3 + 7 = 4 - 6$$

- Ans
- 1. - and =
 - 2. \div and -
 - 3. + and -
 - 4. \div and =

Question Type : MCQ
Question ID : 264330137825
Option 1 ID : 264330539907
Option 2 ID : 264330539908
Option 3 ID : 264330539909
Option 4 ID : 264330539910
Status : Answered
Chosen Option : 1

Q.2 In a certain code language, 'TOURNEY' is written as 'EJNORUY'. How will 'MEDICAL' be written in that language?

- Ans
- 1. ACDIELM
 - 2. ACDEILM
 - 3. ADCLEMI
 - 4. ADCLIEM

Question Type : MCQ
Question ID : 264330135026
Option 1 ID : 264330529042
Option 2 ID : 264330529041
Option 3 ID : 264330529039
Option 4 ID : 264330529040
Status : Answered
Chosen Option : 2

Q.3 Which of the following letter cluster will replace the question mark (?) in the given series?
SE, VI, YM, BQ, EU, ?

- Ans**
- 1. HY
 - 2. JY
 - 3. GY
 - 4. HX

Question Type : MCQ
Question ID : 264330137808
Option 1 ID : 264330539839
Option 2 ID : 264330539840
Option 3 ID : 264330539842
Option 4 ID : 264330539841
Status : Answered
Chosen Option : 1

Q.4 Select the option that is related to the third word in the same way as the second word is related to the first word.
Mary : Divorce :: Native : ?

- Ans**
- 1. Hometown
 - 2. Foreign
 - 3. Country
 - 4. Indoor

Question Type : MCQ
Question ID : 264330137811
Option 1 ID : 264330539851
Option 2 ID : 264330539852
Option 3 ID : 264330539854
Option 4 ID : 264330539853
Status : Answered
Chosen Option : 2

Q.5 Study the given pattern carefully and select the number that can replace the question mark (?) in it.

First row- 7, 9, 63
Second row- 6, 8, 48
Third row- 5, 7, ?

- Ans**
- 1. 28
 - 2. 35
 - 3. 42
 - 4. 49

Question Type : MCQ
Question ID : 264330137824
Option 1 ID : 264330539906
Option 2 ID : 264330539903
Option 3 ID : 264330539904
Option 4 ID : 264330539905
Status : Answered
Chosen Option : 2

Q.6 Two statements are given followed by two conclusions numbered I and II. Assuming the statements to be true, even if they seem to be at variance with commonly known facts, decide which of the conclusions logically follow(s) from the statements.

Statements:

Some cars are fast.

Some fast are slow.

Conclusions:

I. Some cars are not slow.

II. Some slow are fast.

- Ans
- 1. Both conclusions I and II follow
 - 2. Only conclusion II follows
 - 3. Neither conclusion I nor II follows
 - 4. Only conclusion I follows

Question Type : MCQ

Question ID : 264330137819

Option 1 ID : 264330539885

Option 2 ID : 264330539884

Option 3 ID : 264330539886

Option 4 ID : 264330539883

Status : Answered

Chosen Option : 2

Q.7 Ram, Shyam, Pankaj, Tilak, and Gaurav are sitting in a straight line facing south. Tilak and Gaurav are sitting at the ends. Ram is sitting to the immediate left of Gaurav and to the immediate right of Pankaj. Who is sitting to the immediate right of Tilak?

- Ans
- 1. Shyam
 - 2. Pankaj
 - 3. Ram
 - 4. Gaurav

Question Type : MCQ

Question ID : 264330137817

Option 1 ID : 264330539875

Option 2 ID : 264330539876

Option 3 ID : 264330539877

Option 4 ID : 264330539878

Status : Answered

Chosen Option : 1

Q.8 In a certain code language, 'JACKET' is written as 'EAKCTJ'. How will 'BLAZER' be written in that language?

- Ans
- 1. ELRABZ
 - 2. EZLARB
 - 3. ELZARB
 - 4. ELZRAB

Question Type : MCQ

Question ID : 264330135003

Option 1 ID : 264330528950

Option 2 ID : 264330528947

Option 3 ID : 264330528949

Option 4 ID : 264330528948

Status : Answered

Chosen Option : 3

Q.9 Select the option that is related to the third letter cluster in the same way as the second letter cluster is related to the first letter cluster.
GR : KV :: DL : ?

- Ans**
- 1. HQ
 - 2. GP
 - 3. HS
 - 4. HP

Question Type : **MCQ**
Question ID : **264330137810**
Option 1 ID : **264330539847**
Option 2 ID : **264330539848**
Option 3 ID : **264330539850**
Option 4 ID : **264330539849**
Status : **Answered**
Chosen Option : **4**

Q.10 In the following question, select the missing number of the given series.

0, 22, 44, 66,?, 110

- Ans**
- 1. 88
 - 2. 99
 - 3. 94
 - 4. 90

Question Type : **MCQ**
Question ID : **264330138510**
Option 1 ID : **264330542647**
Option 2 ID : **264330542649**
Option 3 ID : **264330542650**
Option 4 ID : **264330542648**
Status : **Answered**
Chosen Option : **1**

Q.11 Priti, Rani, Sriti, Tania, Urusha, and Vidhi are sitting in a circle facing the centre. Vidhi is sitting second to the left of Sriti, and is in between Tania and Urusha. Sriti is not a neighbor to Rani or Tania. Who is sitting to the immediate right of Priti?

- Ans**
- 1. Vidhi
 - 2. Tania
 - 3. Sriti
 - 4. Rani

Question Type : **MCQ**
Question ID : **264330137816**
Option 1 ID : **264330539871**
Option 2 ID : **264330539874**
Option 3 ID : **264330539872**
Option 4 ID : **264330539873**
Status : **Answered**
Chosen Option : **4**

Q.12 By Interchanging the given two numbers which of the following equation will be not correct?

9 and 7

I. $7 \times 3 - 8 + 4 + 9 = 32$

II. $7 - 9 \times 2 + 6 + 3 = -3$

Ans 1. Only II

2. Neither I nor II

3. Both I and II

4. Only I

Question Type : **MCQ**

Question ID : **264330138536**

Option 1 ID : **264330542752**

Option 2 ID : **264330542754**

Option 3 ID : **264330542753**

Option 4 ID : **264330542751**

Status : **Answered**

Chosen Option : **3**



Teachingninja.in

Q.13 Select the correct mirror image of the given figure when the mirror is placed at AB as shown below.

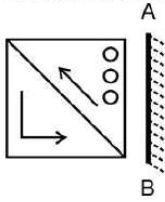

Ans

✓ 1.

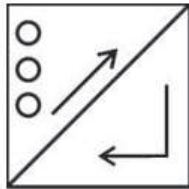

✗ 2.

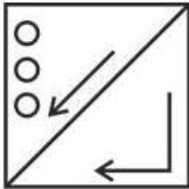

✗ 3.

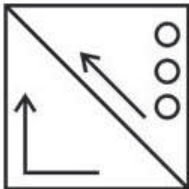

✗ 4.

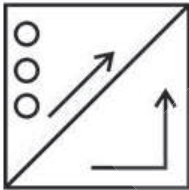

Teachingninja.in

Question Type : MCQ

Question ID : 264330133464

Option 1 ID : 264330522890

Option 2 ID : 264330522888

Option 3 ID : 264330522887

Option 4 ID : 264330522889

Status : Answered

Chosen Option : 1

Q.14 Seven people K, B, M, C, R, P, and S have different heights. C is taller than K. B is shorter than M. P is shorter than M and B. C is not taller than P. S is not taller than K. M is shorter than only one person. Who is the shortest?

- Ans
- 1. K
 - 2. S
 - 3. P
 - 4. B

Question Type : MCQ
Question ID : 264330137818
Option 1 ID : 264330539880
Option 2 ID : 264330539879
Option 3 ID : 264330539881
Option 4 ID : 264330539882
Status : Answered
Chosen Option : 3

Q.15 Which of the following numbers will replace the question mark (?) in the given series?
64, 32, 96, 48, 144, 72, 216, ?

- Ans
- 1. 108
 - 2. 104
 - 3. 112
 - 4. 114

Question Type : MCQ
Question ID : 264330137822
Option 1 ID : 264330539897
Option 2 ID : 264330539898
Option 3 ID : 264330539895
Option 4 ID : 264330539896
Status : Answered
Chosen Option : 1

Q.16 Select the option that is related to the fifth number in the same way as the second number is related to the first number and fourth number is related to third number.

4 : 25 :: 6 : 49 :: 8 : ?

- Ans
- 1. 80
 - 2. 82
 - 3. 85
 - 4. 81

Question Type : MCQ
Question ID : 264330138512
Option 1 ID : 264330542655
Option 2 ID : 264330542657
Option 3 ID : 264330542658
Option 4 ID : 264330542656
Status : Answered
Chosen Option : 4

Q.17 Select the option figure in which the given figure (X) is embedded as its part (rotation is NOT allowed).

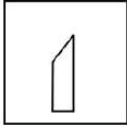

X

Ans

✗ 1.

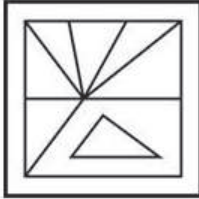

✗ 2.

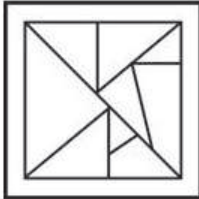

✗ 3.

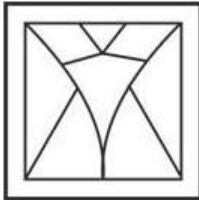

✓ 4.

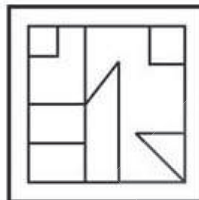

Teachingninja.in

Question Type : MCQ

Question ID : 264330133463

Option 1 ID : 264330522885

Option 2 ID : 264330522883

Option 3 ID : 264330522884

Option 4 ID : 264330522886

Status : Answered

Chosen Option : 4

Q.18 Three statements are given followed by two conclusions numbered I and II. Assuming the statements to be true, even if they seem to be at variance with commonly known facts, decide which of the conclusions logically follow(s) from the statements.

Statements:

Some towels are bright.

Some bright are shiny.

All shiny are little.

Conclusions:

I. Some little are shiny.

II. Some little are bright.

- Ans
- 1. Only conclusion I follows
 - 2. Neither conclusion I nor II follows
 - 3. Only conclusion II follows
 - 4. Both conclusions I and II follow

Question Type : MCQ

Question ID : 264330137820

Option 1 ID : 264330539887

Option 2 ID : 264330539890

Option 3 ID : 264330539888

Option 4 ID : 264330539889

Status : Answered

Chosen Option : 4

Q.19 Select the option figure that will replace the question mark (?) in the figure given below to complete the pattern. (rotation is not allowed)

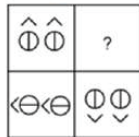

Ans



Question Type : MCQ

Question ID : 264330137829

Option 1 ID : 264330539923

Option 2 ID : 264330539925

Option 3 ID : 264330539924

Option 4 ID : 264330539926

Status : Answered

Chosen Option : 4

Q.20 In a certain code language, 'BMWQ' is coded as '2546', 'WANB' is coded as '6751', 'MOST' is coded as '8249'. What is the code for 'M' in that code language?

- Ans
- 1. 5
 - 2. 6
 - 3. 2
 - 4. 7

Question Type : **MCQ**
Question ID : **264330138587**
Option 1 ID : **264330542957**
Option 2 ID : **264330542956**
Option 3 ID : **264330542955**
Option 4 ID : **264330542958**
Status : **Answered**
Chosen Option : **3**

Section : General Awareness

Q.1 The process of conversion of sugar into alcohol is known as _____.

- Ans
- 1. Denudation
 - 2. Fragmentation
 - 3. Fermentation
 - 4. Infiltration

Question Type : **MCQ**
Question ID : **264330138285**
Option 1 ID : **264330541750**
Option 2 ID : **264330541748**
Option 3 ID : **264330541747**
Option 4 ID : **264330541749**
Status : **Answered**
Chosen Option : **3**

Q.2 Sterility is caused due to the deficiency of which of the following Vitamins?

- Ans
- 1. D
 - 2. E
 - 3. K
 - 4. B1

Question Type : **MCQ**
Question ID : **264330137925**
Option 1 ID : **264330540308**
Option 2 ID : **264330540309**
Option 3 ID : **264330540310**
Option 4 ID : **264330540307**
Status : **Answered**
Chosen Option : **2**

Q.3 In pre-independent India, who was the first person to discuss the concept of poverty line?

- Ans
- 1. M.K Gandhi
 - 2. Mahadev Govind Ranade
 - 3. B.R. Ambedkar
 - 4. Dadabhai Naoroji

Question Type : MCQ
Question ID : 264330133876
Option 1 ID : 264330524529
Option 2 ID : 264330524527
Option 3 ID : 264330524530
Option 4 ID : 264330524528
Status : Answered
Chosen Option : 4

Q.4 Which among the following folk dances is associated with Rajasthan?

- Ans
- 1. Rouf
 - 2. Bihu
 - 3. Lavani
 - 4. Kalbelia

Question Type : MCQ
Question ID : 264330137921
Option 1 ID : 264330540294
Option 2 ID : 264330540291
Option 3 ID : 264330540292
Option 4 ID : 264330540293
Status : Answered
Chosen Option : 4

Q.5 Which among the following states hosted the Track Asia Cup 2022 Cycling Tournament?

- Ans
- 1. Maharashtra
 - 2. Karnataka
 - 3. Kerala
 - 4. West Bengal

Question Type : MCQ
Question ID : 264330137941
Option 1 ID : 264330540374
Option 2 ID : 264330540372
Option 3 ID : 264330540371
Option 4 ID : 264330540373
Status : Answered
Chosen Option : 2

Q.6 The concept of "Republic" in the Indian Constitution was borrowed from the constitution of which of the following countries?

- Ans**
- 1. Germany
 - 2. France
 - 3. Australia
 - 4. Japan

Question Type : **MCQ**
Question ID : **264330137939**
Option 1 ID : **264330540364**
Option 2 ID : **264330540363**
Option 3 ID : **264330540365**
Option 4 ID : **264330540366**
Status : **Answered**
Chosen Option : 1

Q.7 Ustaaad Amjad Ali Khan is associated with which of the following musical instruments?

- Ans**
- 1. Saaranggi
 - 2. Sitar
 - 3. Sarod
 - 4. Veena

Question Type : **MCQ**
Question ID : **264330137937**
Option 1 ID : **264330540358**
Option 2 ID : **264330540357**
Option 3 ID : **264330540355**
Option 4 ID : **264330540356**
Status : **Answered**
Chosen Option : 3

Q.8 Where was the first underground railway started in India?

- Ans**
- 1. Kolkata
 - 2. Mumbai
 - 3. Chennai
 - 4. Pune

Question Type : **MCQ**
Question ID : **264330134703**
Option 1 ID : **264330527770**
Option 2 ID : **264330527769**
Option 3 ID : **264330527767**
Option 4 ID : **264330527768**
Status : **Answered**
Chosen Option : 1

Q.9 The state government of _____ launched the Technology Transfer Scheme in November 2022.

- Ans
- 1. Kerala
 - 2. Tamil Nadu
 - 3. Andhra Pradesh
 - 4. Karnataka

Question Type : MCQ
Question ID : 264330137919
Option 1 ID : 264330540283
Option 2 ID : 264330540286
Option 3 ID : 264330540285
Option 4 ID : 264330540284
Status : Not Answered
Chosen Option : --

Q.10 In which year was All-India Muslim League formed?

- Ans
- 1. 1885
 - 2. 1911
 - 3. 1906
 - 4. 1920

Question Type : MCQ
Question ID : 264330133922
Option 1 ID : 264330524711
Option 2 ID : 264330524713
Option 3 ID : 264330524712
Option 4 ID : 264330524714
Status : Answered
Chosen Option : 3

Q.11 Nadir Shah, ruler of Iran plundered the city of Delhi in _____.

- Ans
- 1. 1739
 - 2. 1771
 - 3. 1748
 - 4. 1761

Question Type : MCQ
Question ID : 264330138293
Option 1 ID : 264330541779
Option 2 ID : 264330541782
Option 3 ID : 264330541780
Option 4 ID : 264330541781
Status : Answered
Chosen Option : 1

Q.12 Which among the following is an autobiography of Michelle Obama?

- Ans
- 1. Me
 - 2. Becoming
 - 3. Our House is on Fire
 - 4. My Life

Question Type : MCQ
Question ID : 264330134711
Option 1 ID : 264330527801
Option 2 ID : 264330527802
Option 3 ID : 264330527800
Option 4 ID : 264330527799
Status : Answered
Chosen Option : 2

Q.13 Which of the following is NOT a family in classification of Modern Indian Languages?

- Ans
- 1. Indo - European
 - 2. Sino - Tibetan
 - 3. Indo - African
 - 4. Dravidian

Question Type : MCQ
Question ID : 264330138340
Option 1 ID : 264330541967
Option 2 ID : 264330541968
Option 3 ID : 264330541970
Option 4 ID : 264330541969
Status : Answered
Chosen Option : 2

Q.14 The Brihadisvara temple at Tanjavur was constructed by _____.

- Ans
- 1. Rajaraja I
 - 2. Rajendra I
 - 3. Vijayalaya
 - 4. Aditya I

Question Type : MCQ
Question ID : 264330138298
Option 1 ID : 264330541799
Option 2 ID : 264330541800
Option 3 ID : 264330541801
Option 4 ID : 264330541802
Status : Answered
Chosen Option : 2

Q.15 How many members in "Council of States" can be nominated by President of India?

- Ans
- 1. 9
 - 2. 15
 - 3. 12
 - 4. 6

Question Type : MCQ
Question ID : 264330138307
Option 1 ID : 264330541836
Option 2 ID : 264330541838
Option 3 ID : 264330541837
Option 4 ID : 264330541835
Status : Answered
Chosen Option : 3

Q.16 Asian Games 2022 held in which country?

- Ans
- 1. India
 - 2. China
 - 3. Japan
 - 4. Singapore

Question Type : MCQ
Question ID : 264330138275
Option 1 ID : 264330541707
Option 2 ID : 264330541709
Option 3 ID : 264330541708
Option 4 ID : 264330541710
Status : Answered
Chosen Option : 3

Q.17 Subsidiary Alliance was a system devised by _____ in 1798

- Ans
- 1. Lord Wellesley
 - 2. Lord Bentinck
 - 3. Lord Dalhousie
 - 4. Lord Hastings

Question Type : MCQ
Question ID : 264330138319
Option 1 ID : 264330541883
Option 2 ID : 264330541886
Option 3 ID : 264330541884
Option 4 ID : 264330541885
Status : Answered
Chosen Option : 3

Q.18 The amount of water recommended by the United Nations for drinking, washing, cooking and maintaining proper hygiene is a minimum of _____ litres per person per day.

- Ans**
- 1. 50
 - 2. 60
 - 3. 40
 - 4. 70

Question Type : **MCQ**
Question ID : **264330138286**
Option 1 ID : **264330541752**
Option 2 ID : **264330541753**
Option 3 ID : **264330541751**
Option 4 ID : **264330541754**
Status : **Answered**
Chosen Option : 1

Q.19 Materials that allow electric current to pass through them are called _____.

- Ans**
- 1. insulators
 - 2. alternator
 - 3. conductors
 - 4. capacitor

Question Type : **MCQ**
Question ID : **264330138287**
Option 1 ID : **264330541756**
Option 2 ID : **264330541757**
Option 3 ID : **264330541755**
Option 4 ID : **264330541758**
Status : **Answered**
Chosen Option : 3

Q.20 What is the upper age limit for appointment as a judge of High court as of October 2022?

- Ans**
- 1. 62 years
 - 2. 57 years
 - 3. 55 years
 - 4. 60 years

Question Type : **MCQ**
Question ID : **264330137940**
Option 1 ID : **264330540370**
Option 2 ID : **264330540369**
Option 3 ID : **264330540367**
Option 4 ID : **264330540368**
Status : **Answered**
Chosen Option : 4

Q.21 Who among the following was the student of 'Pandit Birju Maharaj' and received 'Padma Shri' in the year 1992 and 'Sangeet Natak Akademi Award' in the year 1999-2000?

- Ans
- 1. Kalamandalam Kalyanikutty Amma
 - 2. Mrinalini Sarabhai
 - 3. Yamini Krishnamurthy
 - 4. Shovana Narayan

Question Type : MCQ
Question ID : 264330134713
Option 1 ID : 264330527808
Option 2 ID : 264330527809
Option 3 ID : 264330527807
Option 4 ID : 264330527810
Status : Answered
Chosen Option : 4

Q.22 Which Indian state does not share border with Bangladesh as of 2022?

- Ans
- 1. Meghalaya
 - 2. Bihar
 - 3. West Bengal
 - 4. Mizoram

Question Type : MCQ
Question ID : 264330133919
Option 1 ID : 264330524702
Option 2 ID : 264330524699
Option 3 ID : 264330524701
Option 4 ID : 264330524700
Status : Answered
Chosen Option : 2

Q.23 Which among the following festivals is celebrated in Kerala?

- Ans
- 1. Bonalu
 - 2. Baisakhi
 - 3. Vishu
 - 4. Ambubachi

Question Type : MCQ
Question ID : 264330133909
Option 1 ID : 264330524659
Option 2 ID : 264330524662
Option 3 ID : 264330524661
Option 4 ID : 264330524660
Status : Answered
Chosen Option : 3

Q.24 _____ is the place of confluence for river Alaknanda and Dhauliganga.

- Ans
- 1. Nandaprayag
 - 2. Karnaprayag
 - 3. Vishnuprayag
 - 4. Rudraprayag

Question Type : MCQ
Question ID : 264330137929
Option 1 ID : 264330540324
Option 2 ID : 264330540325
Option 3 ID : 264330540323
Option 4 ID : 264330540326
Status : Answered
Chosen Option : 2

Q.25 _____ refers to sale and purchase of government securities by RBI in the open market with the aim of influencing liquidity in the economy in the medium term.

- Ans
- 1. Marginal Standing Facility
 - 2. Credit Ceiling
 - 3. Open Market Operations
 - 4. Liquidity Adjustment Facility

Question Type : MCQ
Question ID : 264330134718
Option 1 ID : 264330527827
Option 2 ID : 264330527829
Option 3 ID : 264330527828
Option 4 ID : 264330527830
Status : Answered
Chosen Option : 4

Section : English Language and Comprehension

Q.1 Select the most appropriate meaning of the bracketed idiom in the given sentence.

Let the bully have (a taste of his own medicine).

- Ans
- 1. A dangerous person pretending harmless
 - 2. A result that is still unclear and can go either way
 - 3. When you are mistreated the same way you mistreat others
 - 4. A visual presentation is far more descriptive than words

Question Type : MCQ
Question ID : 264330136312
Option 1 ID : 264330534023
Option 2 ID : 264330534024
Option 3 ID : 264330534026
Option 4 ID : 264330534025
Status : Answered
Chosen Option : 3

Q.2 Select the most appropriate word for the given group of words.

A place where snakes are kept

- Ans
- 1. Apiary
 - 2. Hive
 - 3. Aviary
 - 4. Serpentarium

Question Type : MCQ
Question ID : 264330136653
Option 1 ID : 264330535332
Option 2 ID : 264330535334
Option 3 ID : 264330535333
Option 4 ID : 264330535331
Status : Answered
Chosen Option : 4

Q.3 Select the most appropriate antonym of the given word.

Misdemeanour

- Ans
- 1. Offence
 - 2. Amalgamation
 - 3. Obedience
 - 4. Gullible

Question Type : MCQ
Question ID : 264330136683
Option 1 ID : 264330535448
Option 2 ID : 264330535450
Option 3 ID : 264330535449
Option 4 ID : 264330535447
Status : Answered
Chosen Option : 3

Q.4 Select the most appropriate option to fill in the blank.
Different cells express different proteins depending on which promoters are either active or _____.

- Ans
- 1. dormant
 - 2. effectual
 - 3. productive
 - 4. lazy

Question Type : MCQ
Question ID : 264330134396
Option 1 ID : 264330526564
Option 2 ID : 264330526563
Option 3 ID : 264330526566
Option 4 ID : 264330526565
Status : Answered
Chosen Option : 1

Q.5 Identify the segment that contains a grammatical error. If there is no error, select 'No error'

In practice rounds, my caddie, Greg, / and me works on my short/ game with a baseball glove.

- Ans**
- 1. and me works on my short
 - 2. No error
 - 3. game with a baseball glove.
 - 4. In practice rounds, my caddie, Greg,

Question Type : **MCQ**
Question ID : **264330136293**
Option 1 ID : **264330533952**
Option 2 ID : **264330533954**
Option 3 ID : **264330533953**
Option 4 ID : **264330533951**
Status : **Answered**
Chosen Option : **1**

Q.6 Identify the segment that contains a grammatical error. If there is no error, select 'No error'.

None of them, apart from Rohan / and Shilpa, had heard Mohan talk / about what happens that night.

- Ans**
- 1. No error
 - 2. and Shilpa, had heard Mohan talk
 - 3. None of them, apart from Rohan
 - 4. about what happens that night.

Question Type : **MCQ**
Question ID : **264330136691**
Option 1 ID : **264330535482**
Option 2 ID : **264330535480**
Option 3 ID : **264330535479**
Option 4 ID : **264330535481**
Status : **Answered**
Chosen Option : **4**

Q.7 Find the part of the given sentence that has an error in it. If there is no error, choose 'No error'.

Disease-carrying parasites is not picky about hosts.

- Ans**
- 1. about hosts.
 - 2. Disease-carrying parasites
 - 3. No error
 - 4. is not picky

Question Type : **MCQ**
Question ID : **264330135205**
Option 1 ID : **264330529749**
Option 2 ID : **264330529747**
Option 3 ID : **264330529750**
Option 4 ID : **264330529748**
Status : **Answered**
Chosen Option : **4**

Q.8 Choose the word that means the same as the given word.
Assail

- Ans
- 1. Perform
 - 2. Systematic
 - 3. Attack
 - 4. Shield

Question Type : MCQ
Question ID : 264330134415
Option 1 ID : 264330526638
Option 2 ID : 264330526635
Option 3 ID : 264330526636
Option 4 ID : 264330526637
Status : Answered
Chosen Option : 4

Q.9 Improve the underlined part of the sentence. Choose 'No improvement' as an answer if the sentence is grammatically correct.

I like to hang my laundry outside in the suns to dry.

- Ans
- 1. No improvement
 - 2. sun to dried
 - 3. sun to dries
 - 4. sun to dry

Question Type : MCQ
Question ID : 264330134801
Option 1 ID : 264330528150
Option 2 ID : 264330528147
Option 3 ID : 264330528149
Option 4 ID : 264330528148
Status : Answered
Chosen Option : 4

Q.10 Select the most appropriate option to fill in the blank.

I think he is a worthy _____ of the policy and a worthy adversary for the press.

- Ans
- 1. reciprocate
 - 2. placate
 - 3. educate
 - 4. advocate

Question Type : MCQ
Question ID : 264330136297
Option 1 ID : 264330533970
Option 2 ID : 264330533968
Option 3 ID : 264330533969
Option 4 ID : 264330533967
Status : Answered
Chosen Option : 2

Q.11 Select the word segment that substitutes (replaces) the bracketed word segment correctly and completes the sentence meaningfully. Select the option 'no correction required' if the sentence is correct as given.
He looked around for Bunty or Vinay, (but either off) them were anywhere near him.

- Ans**
- 1. No correction required
 - 2. moreover neither of
 - 3. because either of
 - 4. but neither of

Question Type : MCQ
Question ID : 264330136694
Option 1 ID : 264330535494
Option 2 ID : 264330535491
Option 3 ID : 264330535493
Option 4 ID : 264330535492
Status : Answered
Chosen Option : 4

Q.12 A sentence has been given with a blank to be filled with an appropriate option. Choose the correct alternative.
These were two Indian men who _____ hiding in the forest.

- Ans**
- 1. was
 - 2. has been
 - 3. had been
 - 4. have being

Question Type : MCQ
Question ID : 264330134379
Option 1 ID : 264330526500
Option 2 ID : 264330526499
Option 3 ID : 264330526502
Option 4 ID : 264330526501
Status : Answered
Chosen Option : 3

Q.13 Select the most appropriate synonym of the given word.

Disdain

- Ans**
- 1. Contempt
 - 2. Acceptance
 - 3. Admiration
 - 4. Withdraw

Question Type : MCQ
Question ID : 264330136307
Option 1 ID : 264330534006
Option 2 ID : 264330534004
Option 3 ID : 264330534005
Option 4 ID : 264330534003
Status : Answered
Chosen Option : 1

Q.14 Select the most appropriate meaning of the given idiom.

A broth of a boy

- Ans
- 1. Not attached to someone
 - 2. To have specific food choices
 - 3. To behave foolishly
 - 4. A lively, energetic young person

Question Type : MCQ
Question ID : 264330136659
Option 1 ID : 264330535357
Option 2 ID : 264330535356
Option 3 ID : 264330535355
Option 4 ID : 264330535358
Status : Answered
Chosen Option : 2

Q.15 Select the most appropriate antonym to substitute the bracketed word in the given sentence.

There is an unhealthy tendency to (subjugate) films to the dictates of raising public awareness.

- Ans
- 1. Colonize
 - 2. Modest
 - 3. Vanquish
 - 4. Liberate

Question Type : MCQ
Question ID : 264330136310
Option 1 ID : 264330534018
Option 2 ID : 264330534015
Option 3 ID : 264330534017
Option 4 ID : 264330534016
Status : Answered
Chosen Option : 1

Q.16 Select the correctly spelt word.

- Ans
- 1. Porpos
 - 2. Propuse
 - 3. Purpose
 - 4. Purpos

Question Type : MCQ
Question ID : 264330136313
Option 1 ID : 264330534029
Option 2 ID : 264330534028
Option 3 ID : 264330534027
Option 4 ID : 264330534030
Status : Answered
Chosen Option : 3

Q.17 Select the most appropriate option to fill in the blank.

At times he acted as viceroy in William's absence; at times he led the royal forces to _____ rebellions.

- Ans
- 1. scrutinize
 - 2. chastise
 - 3. compromise
 - 4. baptise

Question Type : MCQ
Question ID : 264330136316
Option 1 ID : 264330534039
Option 2 ID : 264330534041
Option 3 ID : 264330534042
Option 4 ID : 264330534040
Status : Answered
Chosen Option : 2

Q.18 Choose the sentence with no spelling error.

- Ans
- 1. I am willing to consider the possibility
 - 2. I am willing to consider the possibility
 - 3. I am wiling to consider the possibility
 - 4. I am willing to consider the possibility.

Question Type : MCQ
Question ID : 264330134395
Option 1 ID : 264330526560
Option 2 ID : 264330526562
Option 3 ID : 264330526561
Option 4 ID : 264330526559
Status : Answered
Chosen Option : 1

Q.19 Select the most appropriate word for the given group of words.

Killing of one person by another

- Ans
- 1. Homicide
 - 2. Fratricide
 - 3. Genocide
 - 4. Filicide

Question Type : MCQ
Question ID : 264330136306
Option 1 ID : 264330533999
Option 2 ID : 264330534002
Option 3 ID : 264330534000
Option 4 ID : 264330534001
Status : Answered
Chosen Option : 1

Q.20 Select the word segment that substitutes (replaces) the bracketed word segment correctly and completes the sentence meaningfully. Select the option 'no correction required' if the sentence is correct as given.

It was a (easement to be far away) from that malicious old labyrinth with its stares and gossip.

- Ans**
- 1. help to be away
 - 2. relief to be away
 - 3. No correction required
 - 4. rest to be far

Question Type : MCQ
Question ID : 264330136389
Option 1 ID : 264330534323
Option 2 ID : 264330534324
Option 3 ID : 264330534326
Option 4 ID : 264330534325
Status : Answered
Chosen Option : 2

Comprehension:

In the following passage some words have been deleted. Fill in the blanks with the help of the alternatives given. Select the most appropriate option for each number.

English Ivy (1) _____ its poor reputation as a nuisance by its unparalleled ability to provide shade. By seamlessly covering the exterior of a building, it works as a natural (2) _____, blocking the sun and decreasing air conditioning costs. This means big savings for both building tenants and homeowners (3) _____. And it can happen quickly, too. Under the proper conditions, established English Ivy can grow to cover (4) _____ of roughly 500 square feet per year. Given that most homes have a roof measuring roughly 2000 square feet, ivy-friendly homeowners can rest assured that their roofs will be (5) _____ covered in about four years.

SubQuestion No : 21

Q.21 Select the most appropriate option to fill in blank number 1.

- Ans**
- 1. portrays
 - 2. follows
 - 3. betrays
 - 4. punishes

Question Type : MCQ
Question ID : 264330136674
Option 1 ID : 264330535411
Option 2 ID : 264330535414
Option 3 ID : 264330535412
Option 4 ID : 264330535413
Status : Answered
Chosen Option : 1

Comprehension:

In the following passage some words have been deleted. Fill in the blanks with the help of the alternatives given. Select the most appropriate option for each number.

English Ivy (1) _____ its poor reputation as a nuisance by its unparalleled ability to provide shade. By seamlessly covering the exterior of a building, it works as a natural (2) _____, blocking the sun and decreasing air conditioning costs. This means big savings for both building tenants and homeowners (3) _____. And it can happen quickly, too. Under the proper conditions, established English Ivy can grow to cover (4) _____ of roughly 500 square feet per year. Given that most homes have a roof measuring roughly 2000 square feet, ivy-friendly homeowners can rest assured that their roofs will be (5) _____ covered in about four years.

SubQuestion No : 22

Q.22 Select the most appropriate option to fill in blank number 2.

- Ans
- 1. modulator
 - 2. postulator
 - 3. insulator
 - 4. regulator

Question Type : MCQ
Question ID : 264330136675
Option 1 ID : 264330535416
Option 2 ID : 264330535417
Option 3 ID : 264330535415
Option 4 ID : 264330535418
Status : Answered
Chosen Option : 3

Comprehension:

In the following passage some words have been deleted. Fill in the blanks with the help of the alternatives given. Select the most appropriate option for each number.

English Ivy (1) _____ its poor reputation as a nuisance by its unparalleled ability to provide shade. By seamlessly covering the exterior of a building, it works as a natural (2) _____, blocking the sun and decreasing air conditioning costs. This means big savings for both building tenants and homeowners (3) _____. And it can happen quickly, too. Under the proper conditions, established English Ivy can grow to cover (4) _____ of roughly 500 square feet per year. Given that most homes have a roof measuring roughly 2000 square feet, ivy-friendly homeowners can rest assured that their roofs will be (5) _____ covered in about four years.

SubQuestion No : 23

Q.23 Select the most appropriate option to fill in blank number 3.

- Ans
- 1. unlike
 - 2. likely
 - 3. dislike
 - 4. alike

Question Type : MCQ
Question ID : 264330136676
Option 1 ID : 264330535422
Option 2 ID : 264330535419
Option 3 ID : 264330535420
Option 4 ID : 264330535421
Status : Answered
Chosen Option : 4

Comprehension:

In the following passage some words have been deleted. Fill in the blanks with the help of the alternatives given. Select the most appropriate option for each number.

English Ivy (1) _____ its poor reputation as a nuisance by its unparalleled ability to provide shade. By seamlessly covering the exterior of a building, it works as a natural (2) _____, blocking the sun and decreasing air conditioning costs. This means big savings for both building tenants and homeowners (3) _____. And it can happen quickly, too. Under the proper conditions, established English Ivy can grow to cover (4) _____ of roughly 500 square feet per year. Given that most homes have a roof measuring roughly 2000 square feet, ivy-friendly homeowners can rest assured that their roofs will be (5) _____ covered in about four years.

SubQuestion No : 24

Q.24 Select the most appropriate option to fill in blank number 4.

- Ans
- 1. a lake
 - 2. an area
 - 3. a surface
 - 4. a wall

Question Type : **MCQ**
Question ID : **264330136677**
Option 1 ID : **264330535424**
Option 2 ID : **264330535426**
Option 3 ID : **264330535423**
Option 4 ID : **264330535425**
Status : **Answered**
Chosen Option : **4**

Comprehension:

In the following passage some words have been deleted. Fill in the blanks with the help of the alternatives given. Select the most appropriate option for each number.

English Ivy (1) _____ its poor reputation as a nuisance by its unparalleled ability to provide shade. By seamlessly covering the exterior of a building, it works as a natural (2) _____, blocking the sun and decreasing air conditioning costs. This means big savings for both building tenants and homeowners (3) _____. And it can happen quickly, too. Under the proper conditions, established English Ivy can grow to cover (4) _____ of roughly 500 square feet per year. Given that most homes have a roof measuring roughly 2000 square feet, ivy-friendly homeowners can rest assured that their roofs will be (5) _____ covered in about four years.

SubQuestion No : 25

Q.25 Select the most appropriate option to fill in blank number 5.

- Ans
- 1. obsoletely
 - 2. completely
 - 3. incompletely
 - 4. repletely

Question Type : **MCQ**
Question ID : **264330136678**
Option 1 ID : **264330535428**
Option 2 ID : **264330535427**
Option 3 ID : **264330535430**
Option 4 ID : **264330535429**
Status : **Answered**
Chosen Option : **2**